

UNCONTROLLED

MACHINING DEVIATIONS FOR LINEAR DIMENSIONS	RANGE	0 - 6	6 - 30	30 - 120	120 - 315	315 - 1000	1000 - 2000	2000 - 4000	ABOVE 4000	RA
TOLERANCE										~
FOR DIMENSIONAL TOLERANCES OF SHEET METAL PARTS AND WELDED STRUCTURES, REFER STD. RD-227										
UNSPECIFIED TOLERANCE FOR LINEAR AND ANGULAR DIMENSIONS REF. IS 2102 (PT-1) (MEDIUM)									QUALITY OF WELD JOINTS REF. RD 230 MEDIUM	
VALUES OF SURFACE TEXTURE SHALL BE AS PER COMPANY STD DS. 1012.C									STATUS:	
WELDING SHALL BE CARRIED OUT AS PER IS. 9595-96										

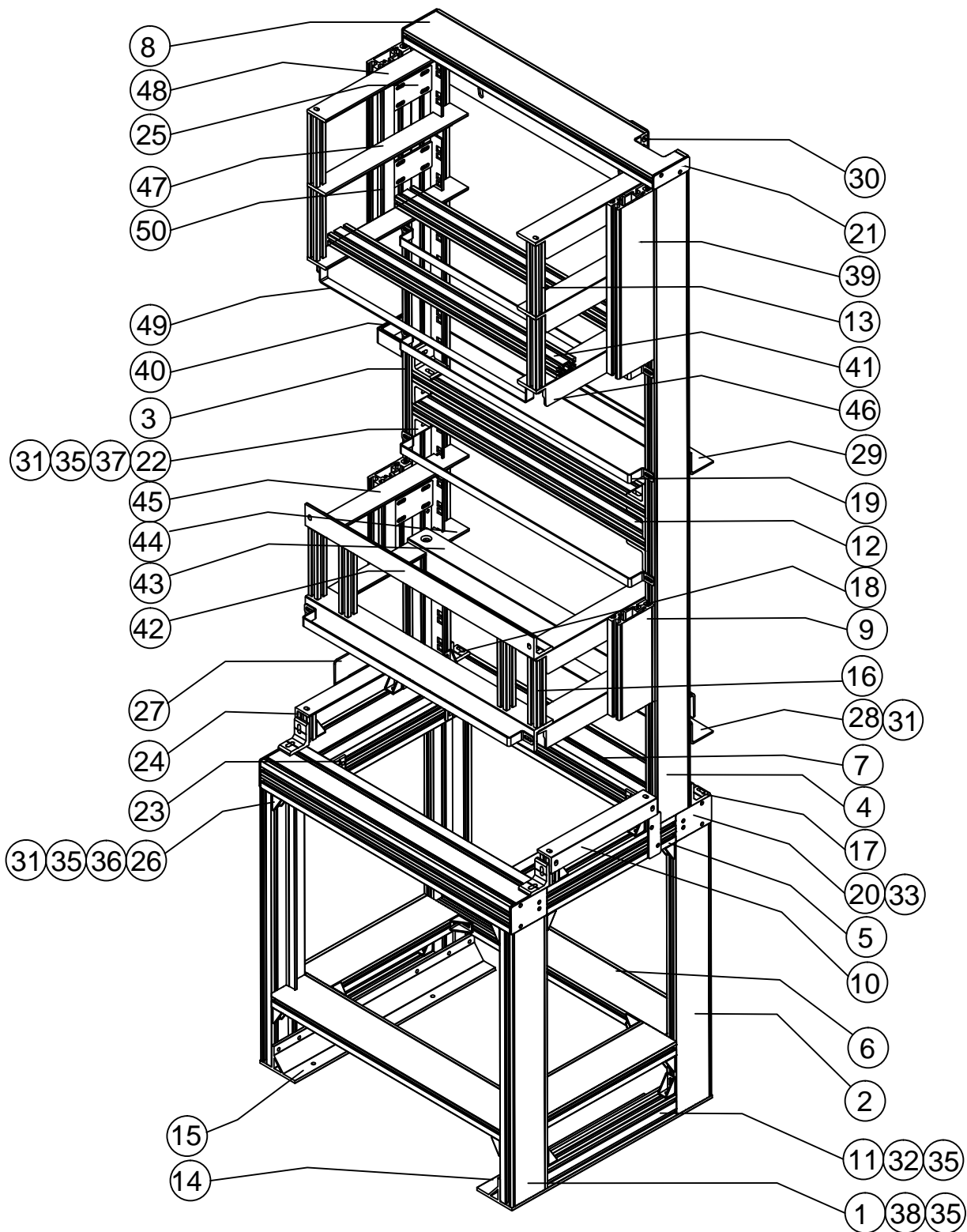

50	6	926-50262	EARTHING BRACKET		SM ALU-3MM
49	2	942-50236-2	WIRE SUPPORT		THK-2.5,SS304
48	2	942-50243-6	L ANGLE LH & RH	L-298	EXTRUSION REF 942-50210
47	2	942-50243-5	L ANGLE LH & RH	L-298	EXTRUSION REF 942-50210
46	2	942-50243-4	L ANGLE LH & RH	L-298	EXTRUSION REF 942-50210
45	2	942-50243-3	L ANGLE LH & RH	L-298	EXTRUSION REF 942-50210
44	2	942-50243-2	L ANGLE LH & RH	L-298	EXTRUSION REF 942-50210
43	1	942-50243-1	L ANGLE MIDDLE	L-490	EXTRUSION REF 942-50210
42	2	942-50243	L-ANGLE BOTTOM	L-490	EXTRUSION REF, 942-50210
41	2	942-50031-16	FRAME MIDDLE	L-490	EXTRUSION REF, 942-50206
40	2	942-50031-40	VELCRO CLOTH	300x50x2	STD B 0
39	2	926-50135-1	FRAME LH & RH	L-310	EXTRUSION REF, 942-50202
38	20	RFS5960520	Hex.Soc head cap allen Bolt M5X20 to IS:2269/ Matl:IS-1367 (P-14) Gr-A2-70,Stainless steel		
37	44	RFS5960508	Hex.Soc head cap allen Bolt M5X8 to IS:2269/ Matl:IS-1367 (P-14) Gr-A2-70,Stainless steel		
36	100	RFS5960516	Hex.Soc head cap allen Bolt M5X16 to IS:2269/ Matl:IS-1367 (P-14) Gr-A2-70,Stainless steel		
35	264	RFW0920512	SPRING WASHER B5 TO IS:3063(TAR-1)MATI; AISI,304,STAINLESS STEEL		
34	120	RFS5960512	Hex.Soc head cap allen Bolt M5X12 to IS:2269/ Matl:IS-1367 (P-14) Gr-A2-70,Stainless steel		
33	22	RFS7420512	Cross recessed CSK head screw M5X12 to IS:7485/ Matl:ISO-3506-79 Gr-A2-70,Stainless steel		
32	100	942-50230-1	NUT PAD-M5		THK-2.5,SS304
31	164	942-50230	NUT PAD-M5		THK-3,SS304
30	1	942-50249	BACK PLATE LH		SM ,THK-3,SS304
29	1	942-50248	Z-PLATE-2 LH		SM ,THK-3,SS304
28	1	942-50247	Z-PLATE-1 LH		SM ,THK-3,SS304
27	1	942-50246	U-BRACKET		SM ,THK-3,ALU5052
26	42	942-50245	SUPPORT BRACKET ASSY,		SM ,THK-1.5,SS304
25	6	942-50241	WALL PLATE		SM ,THK-3,ALU5052
24	2	926-50039-15	FRAME LH & RH	L-55	EXTRUSION REF 942-50204
23	4	942-50242	L-ANGLE LH & RH		EXTRUSION REF 942-50210-1
22	6	942-50261	L ANGLE LH & RH		EXTRUSION REF, 942-50210
21	4	942-50240	END CAP PLATE-2,LH&RH		SM ,THK-3,ALU5052
20	4	942-50239	END CAP PLATE-1,LH&RH		SM ,THK-3,ALU5052
19	3	942-50236-1	WIRE SUPPORT		SM ,THK-2.5,SS304
18	1	942-50229	L-ANGLE LH	L-25	EXTRUSION REF, 942-50210
17	1	942-50228	L-ANGLE RH	L-25	
16	2	926-50039-14	FRAME LH & RH	L-123	EXTRUSION REF 942-50204
15	1	942-50226	BASE LH	L-420	EXTRUSION REF, 942-50209
14	1	942-50225	BASE RH	L-420	
13	6	926-50039-13	FRAME LH & RH	L-129	EXTRUSION REF 942-50204
12	2	942-50031-12	FRAME MIDDLE	L-499.5	EXTRUSION REF, 942-50206
11	2	942-50031-11	FRAME LH & RH	L-270	
10	2	926-50136	L-ANGLE LH & RH	L-222	EXTRUSION REF 942-50210-1
9	2	926-50135	FRAME LH & RH	L-175	EXTRUSION REF, 942-50202
8	1	942-50219	FRAME LH TOP	L-534	
7	4	942-50031-7	FRAME FRONT & BACK	L-534	EXTRUSION REF 942-50203
6	2	942-50031-6	FRAME FRONT & BACK	L-490	
5	6	942-50031-5	FRAME LH & RH	L-270	
4	1	942-50214	FRAME RH	L-1165	
3	1	942-50213	FRAME LH	L-1165	EXTRUSION REF, 942-50202
2	2	942-50212	FRAME LH & RH	L-500	
1	2	942-50211	FRAME LH & RH	L-500	

SL.No	QTY	PART No.	DESCRIPTION	SIZE	COMPANY STD./IS	Wt. (Kg)
MATERIAL						
△			PRODUCT	BMRL METRO CARS		
△			REF. DRG.			
△			MATERIAL			
△			HEAT TREAT.	APPD	VS	22.03.19
△			SURFACE TREAT.	REV D		
△			CHKD	SNH		
△			DRWN	SNH		21.03.19
△			SCALE	2 OF 2		
△			DRG No.	926-50039		
ALT. NO.	EEN NO/CHANGES					

NOTE:

- ALL DIMENSIONS ARE IN mm
- ALL ALUMINIUM PARTS SHALL BE ANODISED TO Gr.AC15 of IS:1868.
- ITEM-40 VELCRO CLOTH OF LENGTH 230 SHALL BE FIXED WITH SUITABLE RIVET TO FRAME